

TWFK-31082-B35
SHT 1.1

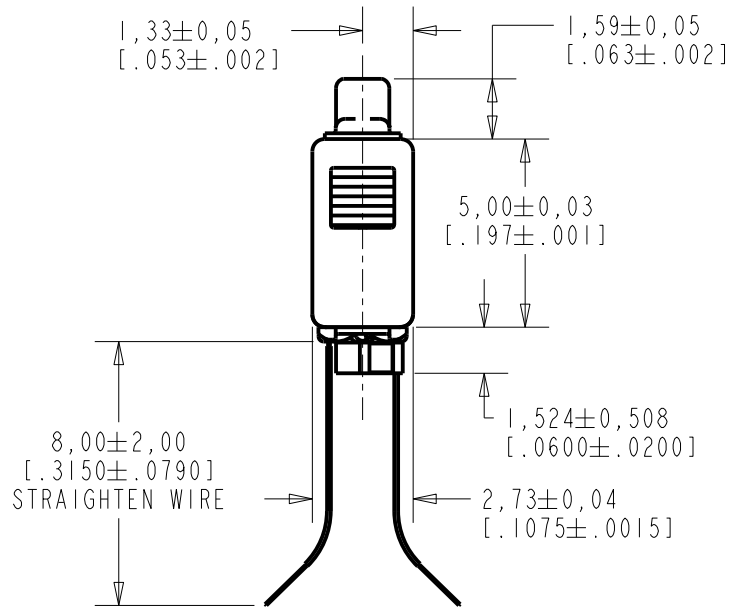

- NOTES:
- 1 A POSITIVE GOING VOLTAGE AT TERMINAL 2, RELATIVE TO TERMINAL 1, CAUSES A DECREASE IN PRESSURE AT THE SOUND OUTLET.
 - 2 LOCATED FROM TWO SURFACES FOR CUSTOMER CONVENIENCE. ONLY APPLICABLE FROM ONE SURFACE, NOT TO BE USED TOGETHER.

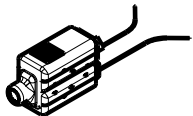
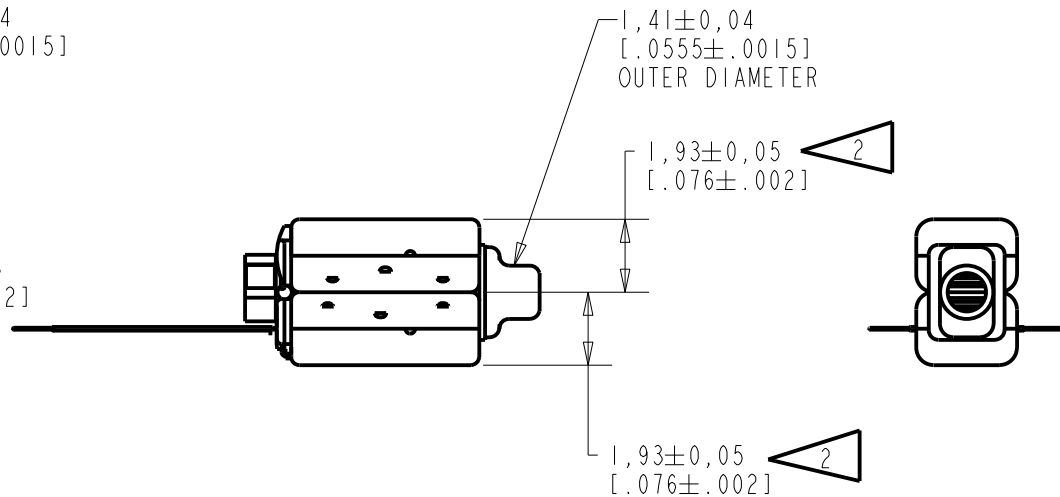
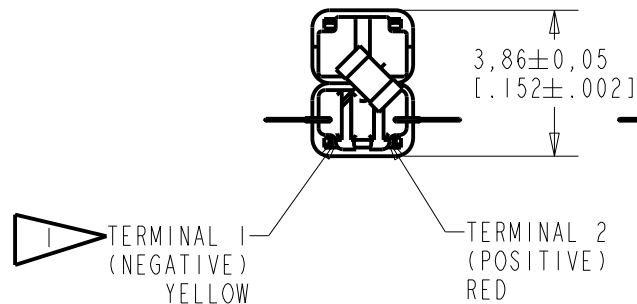

SCALE 2:1 DIMENSIONS IN MILLIMETERS [INCHES]

Revision	C.O. #	Implementation Date	RELEASE LEVEL	REVISION
A	C40100711	7-25-11	Active	A

SCALE: 5:1	DR. BY: LSY	DATE: 7-25-11
DO NOT SCALE DRAWING	CK. BY: GJP	DATE: 7-28-11
TITLE: RECEIVER	APP. BY: GJP	DATE: 7-28-11
OUTLINE DRAWING	TWFK-31082-B35 SHT 1.1	

KNOWLES ELECTRONICS
ITASCA, ILLINOIS U.S.A.

CONSTANT VOLTAGE DRIVE CONDITIONS

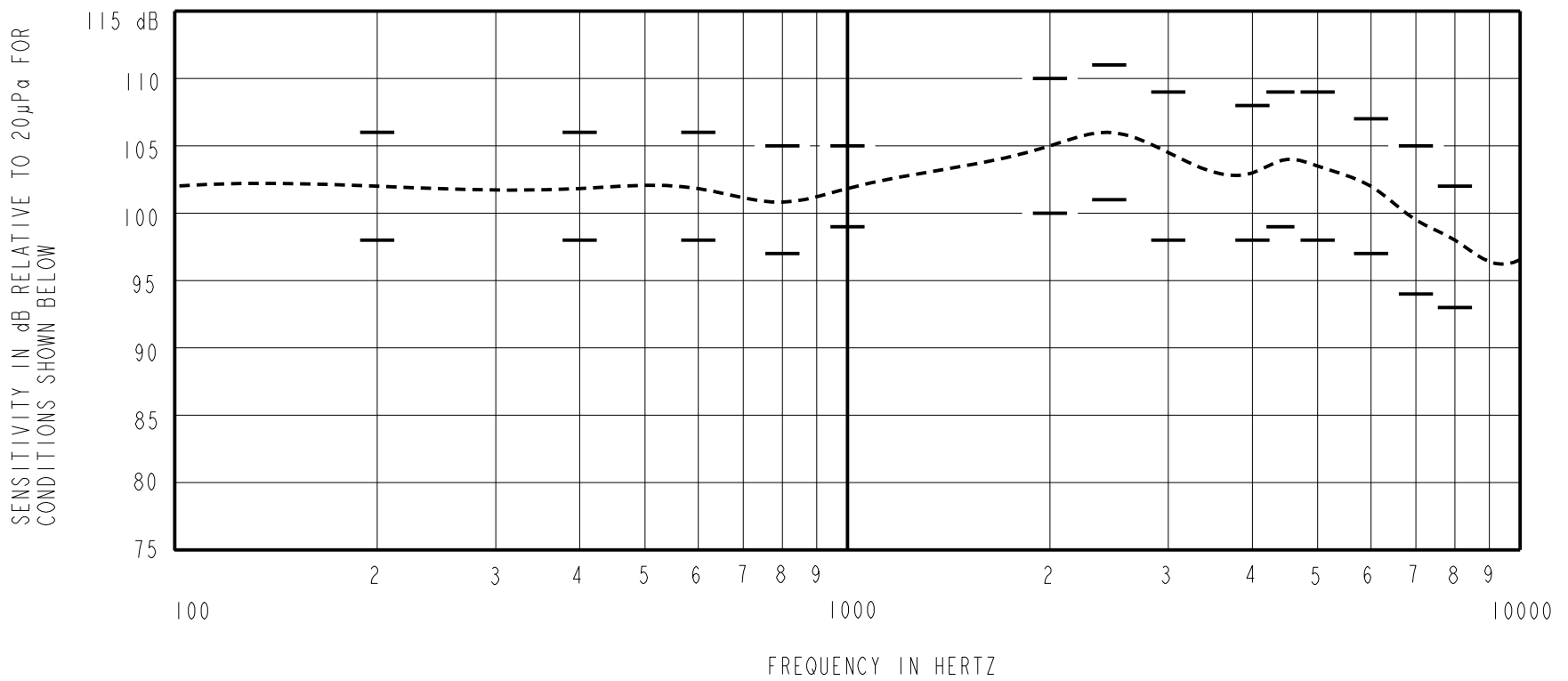

ACOUSTICAL

SENSITIVITY*
DEVICE WILL PRODUCE THE SPL LISTED BELOW UNDER TEST CONDITION IN TABLE 3.
NOMINAL SENSITIVITY AT 1kHz IS dB RELATIVE TO 20 µPa. ALL OTHER VALUES IN dB RELATIVE TO THE SENSITIVITY AT 1kHz.

FREQUENCY (Hz)	MINIMUM	NOMINAL	MAXIMUM
200	-4.0	+0.0	+4.0
400	-4.0	+0.0	+4.0
600	-4.0	+0.0	+4.0
800	-5.0	-1.0	+3.0
1000	-3.0	102.0	+3.0
2000	-2.0	+3.0	+8.0
2500	-1.0	+4.0	+9.0
3000	-4.0	+1.5	+7.0
4000	-4.0	+1.0	+6.0
4500	-3.0	+2.0	+7.0
5000	-4.0	+1.5	+7.0
6000	-5.0	+0.0	+5.0
7000	-8.0	-2.5	+3.0
8000	-9.0	-4.0	+1.0

TABLE 1

MECHANICAL

PORT LOCATION: 12S

SOLDER TYPE: SAC305 (LEAD FREE)

TEMPERATURE:

OPERATING: SENSITIVITY AT 1KHz WILL NOT VARY BY MORE THAN +1/-3 dB FROM 17°C TO 63°C

STORAGE: -40°C TO 63°C.

BUZZ TEST

LISTENING TEST CONDUCTED BETWEEN 20Hz TO 20KHz TO DETECT BUZZ.

INPUT VOLTAGE DRIVE SIGNAL	.13 Vrms
----------------------------	----------

TABLE 5

TOTAL HARMONIC DISTORTION
DEVICE WILL NOT EXCEED TOTAL HARMONIC DISTORTION LEVELS LISTED BELOW.

FREQUENCY (Hz)	AC DRIVE (Vrms)	DC BIAS (mA)	LIMIT (%)
1000	0.085	0	5

TABLE 2

TEST CONDITIONS

NOMINAL SOURCE VOLTAGE	0.085 Vrms, 0 V DC BIAS
SOURCE IMPEDANCE	<1 Ohm
TUBING	NONE
COUPLER CAVITY + CAP	IEC 60318-4 (711) + TA-1158-RD
TEST STATION	CLIO SYSTEM

TABLE 3

ELECTRICAL

DC RESISTANCE	25 Ohms ± 10%
IMPEDANCE @ 1kHz	51.5 Ohms ± 15%

TABLE 4

ISOLATION: CASE WILL BE ELECTRICALLY ISOLATED FROM THE COIL CIRCUIT.

Revision	C.O. #	Implementation Date	RELEASE LEVEL	REVISION
A	C40100711	7-25-11	Active	A

WHEN TEST LIMITS ARE USED TO ESTABLISH INCOMING INSPECTION ACCEPTANCE/REJECTION CRITERIA, CORRELATION OF TEST EQUIPMENT WITH KNOWLES IS ALSO REQUIRED FOR ELIMINATION OF EQUIPMENT AND TEST METHOD VARIATION		DR. BY	DATE
TITLE: RECEIVER PERFORMANCE SPECIFICATION		LSY	7-25-11
		GJP	7-28-11
		GJP	7-28-11

KNOWLES ELECTRONICS
ITASCA, ILLINOIS U.S.A.

TWFK-31082-B35
SHT 2.1